

# Worthington City School District School Board Meeting

February 11, 2019



An aerial photograph of the McCord Middle School campus. A color-coded floor plan is overlaid on the building's footprint. The plan includes various colored sections: green for a large rectangular building on the left, pink for a central building, purple for a building to the right of the center, yellow for a large section at the bottom, and orange for smaller sections. The school is situated next to a large parking lot on the left and a basketball court above it. A road runs along the bottom and left sides of the campus. 

## McCord Middle School

600

### OPPORTUNITIES / NEEDS

- ease of site accomodation
- new science labs
- secure entry/admin location
- expand student dining
- site drop-off separation

### CHALLENGES

- land-locked existing dining
- natural daylighting deficiencies
- 
- 
- 

**McCord Middle School - Existing Site**



# Worksheet Summary

McCord Middle School - POR

Enter Grade Configuration:	6-8
Enter Student Enrollment	600
Square Feet Per Student from Page 2000-3	142.88
<b>Total Gross Square Feet Funded</b>	<b>85,725</b>
<b>SELECT ONE</b> <input checked="" type="radio"/> Single or Two Story Buildings <input type="radio"/> 3 Stories or greater	
Vert. Cir. Area Allowance (3 Stories or greater)	0
<b>Total Adjusted POR Gross Square Footage</b>	<b>85,725</b>

Vertical Circulation (3 Stories or greater)  
refers only to stairways/stairtowers,  
monumental stairs, elevators and  
elevator equipment rooms.

new sf	10,442
reprogram sf	5,938

PROGRAM AREA		New SF	Exst. SF*	TOTAL SF
M-AC	Academic Core Spaces	6,768	20,931	27,699
M-SE	Special Education Spaces	0	1,577	1,577
M-AD	Administrative Spaces	0	2,564	2,564
M-MC	Media Center Spaces	0	3,024	3,024
M-VA	Visual Arts Spaces	0	1,581	1,581
M-MU	Music Spaces	1,896	1,293	3,189
M-TE	Technology Education Spaces	0	2,656	2,656
M-FCS	Family and Consumer Science Spaces	0	0	0
M-PE	Physical Education Spaces	0	11,451	11,332
M-SD	Student Dining Spaces	0	4,608	4,608
M-FS	Food Service Spaces	0	2,053	2,053
M-CU	Custodial Spaces	0	115	115
M-BS	Building Services	1,178	18,259	19,437
<b>Facility Total</b>		<b>9,842</b>	<b>70,112</b>	<b>79,835</b>
Construction Factor (11% multiplied by the facility total)		0.06	0.07	na
<b>Gross Square Feet (GSF) Developed</b>		<b>10,442</b>	<b>75,089</b>	<b>85,531</b>
Minus exst. co-funded Oversize Area from Master Plan			0	-
Adjusted Existing Area			75,089	-
<b>Total Adjusted GSF Developed (without Oversize Area)</b>				<b>85,531</b>
Difference of GSF developed from GSF allowable				<b>194</b>

See Note 1

See Note 2

## Worksheet Summary Notes

Number	Notes:
1	Existing Gross Square Feet taken from master facility plan.
2	Oversize Area also taken from master facility plan.
*	The Existing SF column is used in projects where there are to be building additions or renovations.

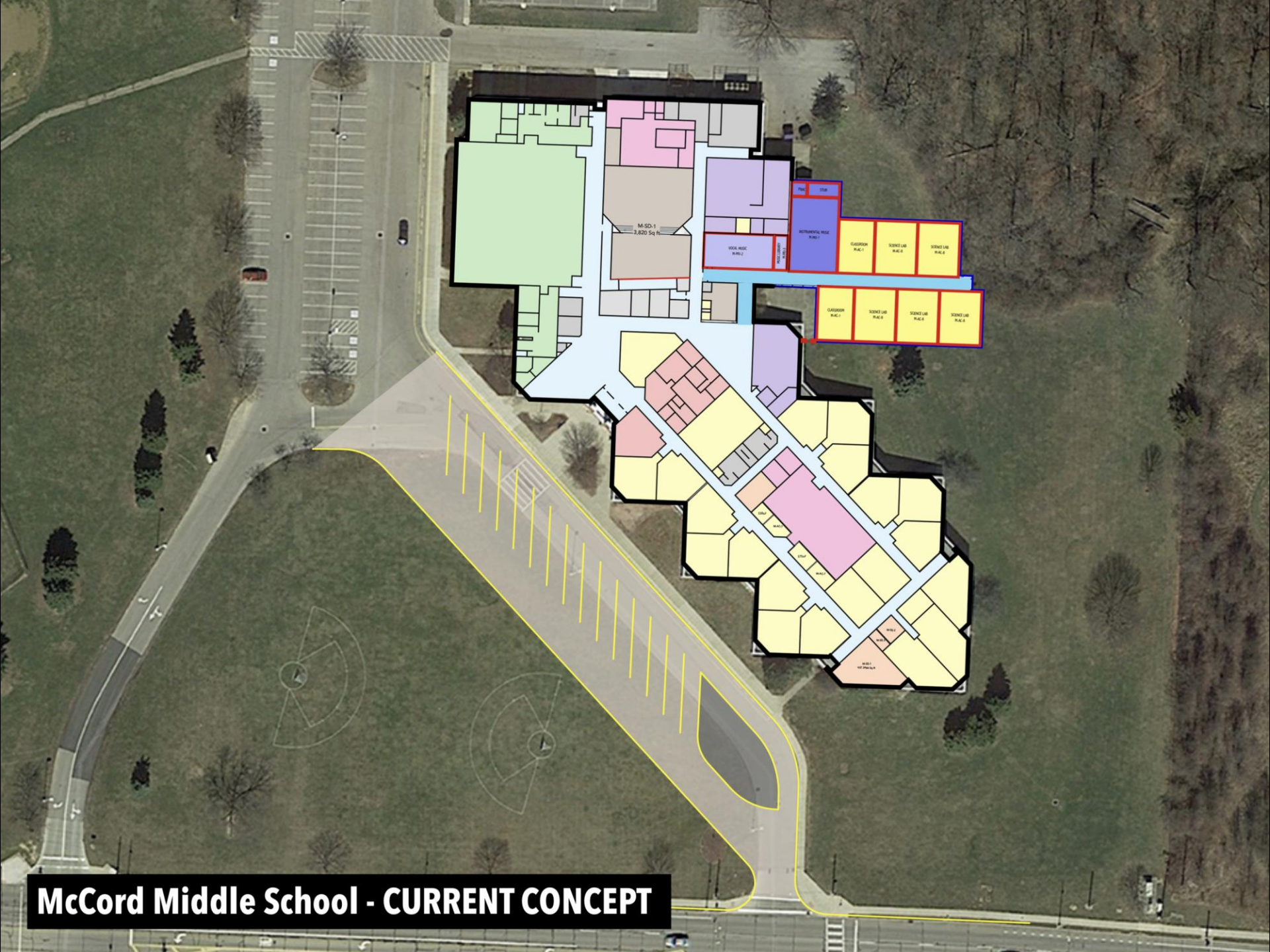

**McCord Middle School - CURRENT CONCEPT**



**10,442 Sq ft Total Addition**

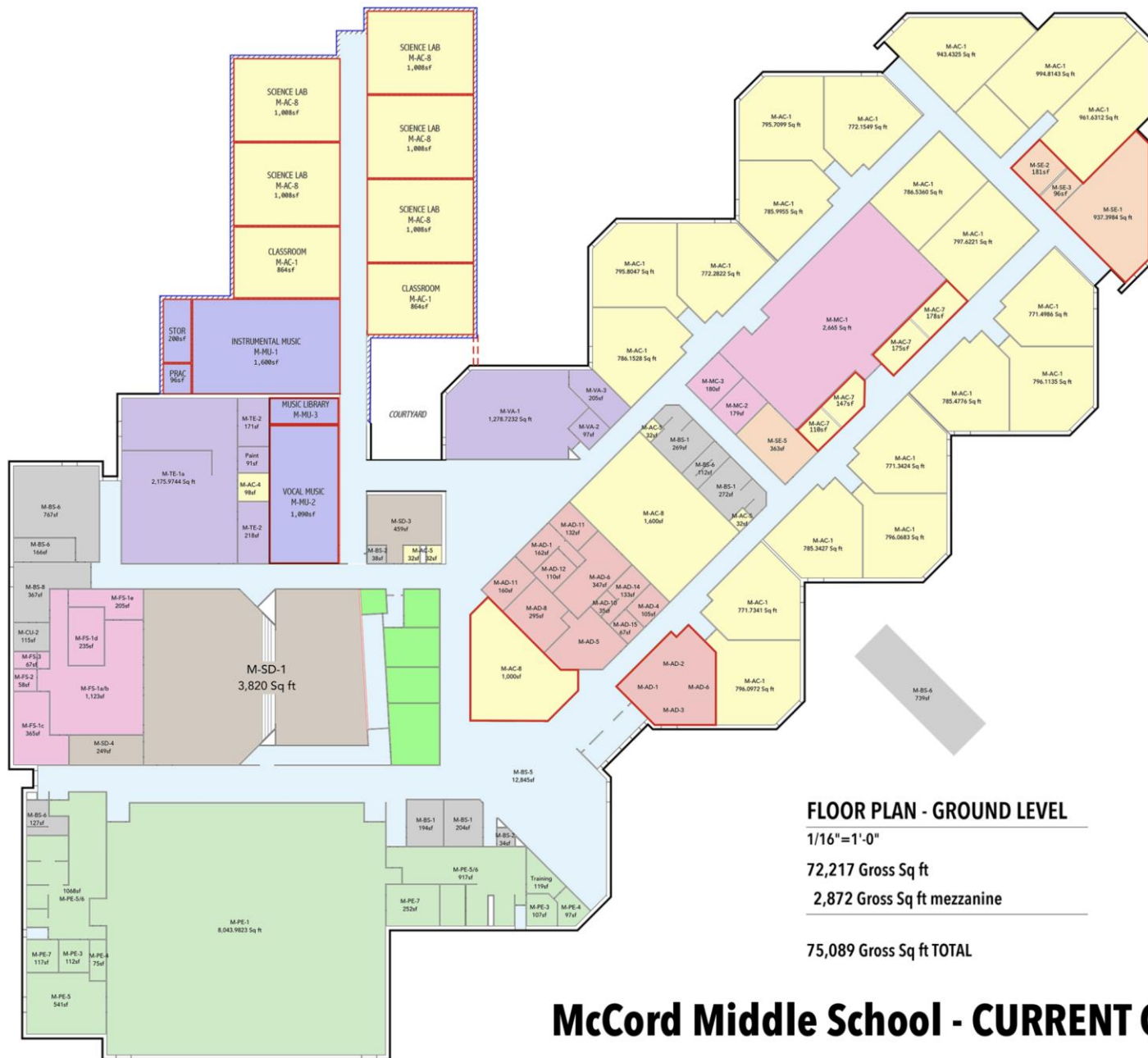

### FLOOR PLAN - GROUND LEVEL

$$1/16'' = 1'-0''$$

72,217 Gross Sq ft

2,872 Gross Sq ft mezzanine

**75,089 Gross Sq ft TOTAL**

## McCord Middle School - CURRENT CONCEPT

# Perry/Phoenix Middle School - Existing Site

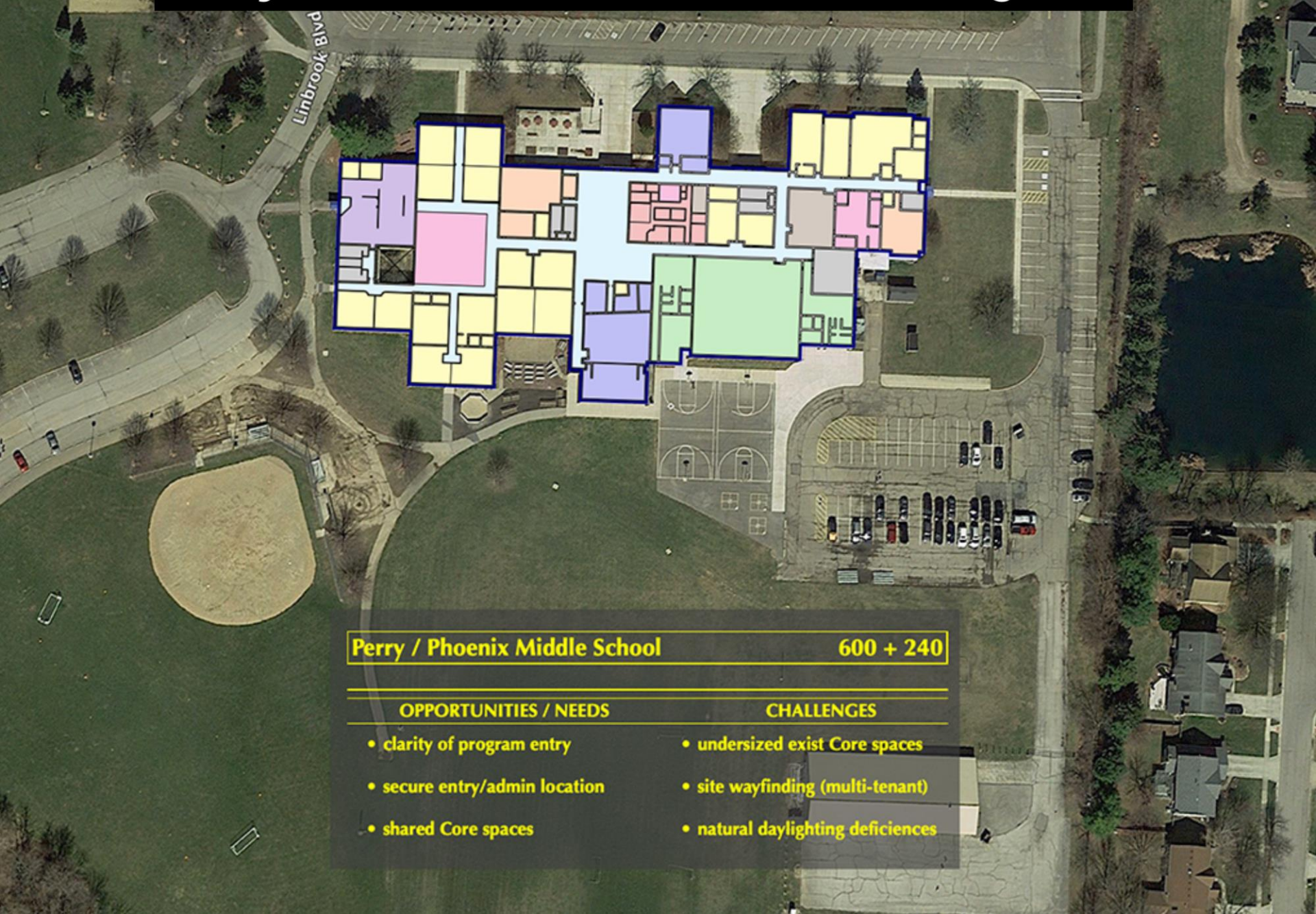

## Perry / Phoenix Middle School

600 + 240

### OPPORTUNITIES / NEEDS

- clarity of program entry
- secure entry/admin location
- shared Core spaces

### CHALLENGES

- undersized exist Core spaces
- site wayfinding (multi-tenant)
- natural daylighting deficiencies



14,671 Sq ft

VISITORS / PARENT DROP-OFF LANE

Linbrook Blvd

Admin  
W.A.

Multi-use Studio

1

Admin  
Phoenix

Admin  
Perry

Tech  
1,500sf

Media Center  
3,900sf

Art  
1,500sf

Art  
1,200sf

Vocal  
1,330sf

WORTHINGTON  
ACADEMY

Multi-use Studio  
PHOENIX  
ACADEMY  
Multi-use Studio

Student  
Commons

Student Dining  
4,300sf

LGRR

Food Service  
3,000sf

ROCKBRIDGE  
ACADEMY

Locker Bay

Lckr Rm

Gym  
5,800sf  
+

Mech  
3,000sf

Lckr Rm

Instrumental  
3,000sf

Stage  
1,400sf

2,900sf new

Lab

Lab

Perry MS

2 story

Academic  
Wing

BUS DROP - OFF

STAFF PARKING

45,931 Sq ft

**Perry / Phoenix Middle School  
CURRENT CONCEPT**

14,671 Sq ft

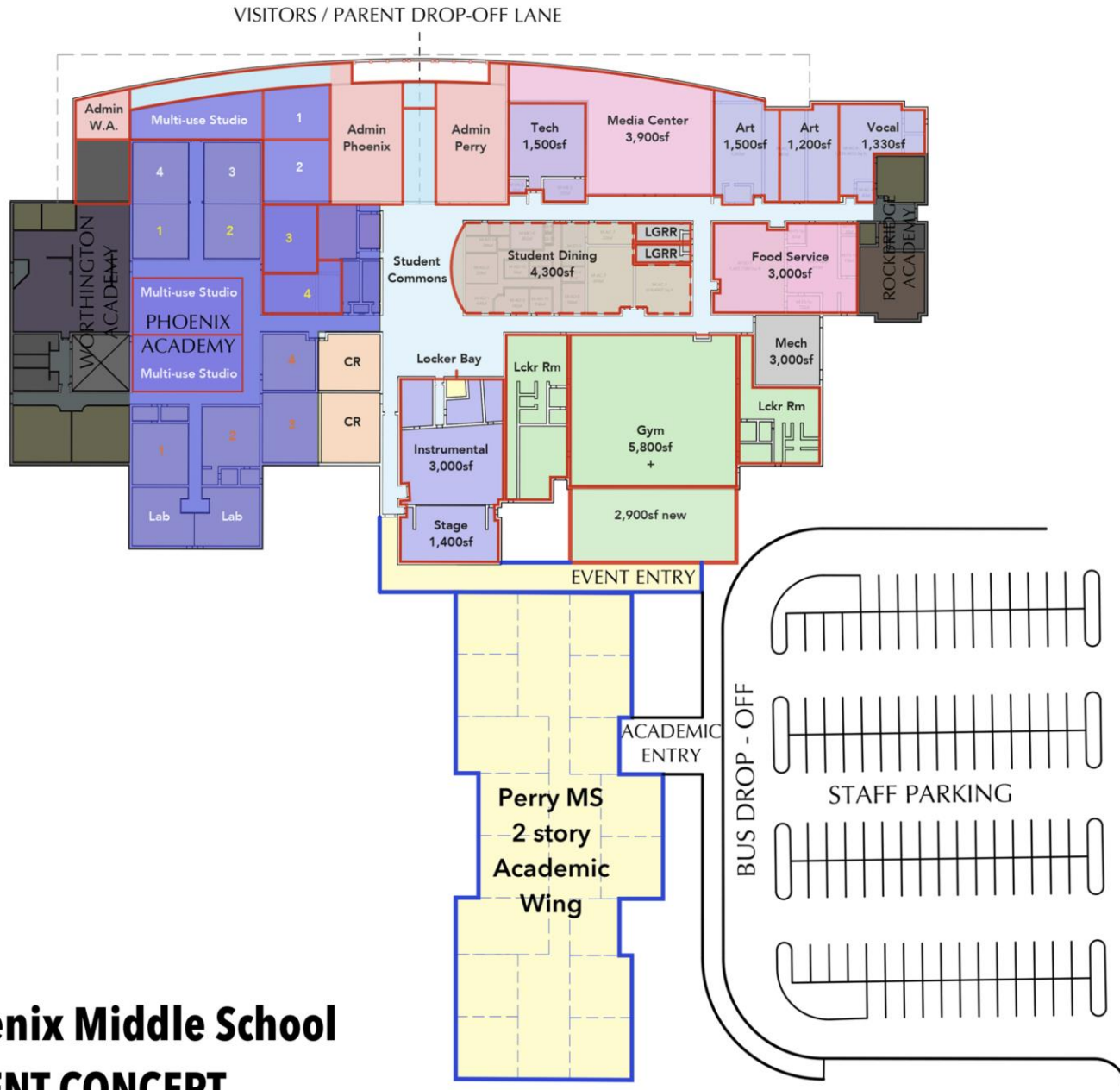

**Perry / Phoenix Middle School**  
**CURRENT CONCEPT**



**Kilbourne Middle School****600****OPPORTUNITIES / NEEDS**

- additional CR space
- expand student dining
- secure entry/admin location
- site drop-off separation

**CHALLENGES**

- difficult site accomodation
- remote parking ?

Hartford St

**Kilbourne Middle School - Existing Site**



## FLOOR PLAN - GROUND LEVEL

1/16"=1'-0"

51,799 Gross Sq ft

97,392 Gross Sq ft TOTAL

5,592 GSF Oversize (Auditorium)

5,274 GSF Oversize (Corridors)

1,360 GSF Oversize (Media Ctr)

5,444 GSF Oversize (Const Factor)

79,722 OFCC Gross Sq Ft

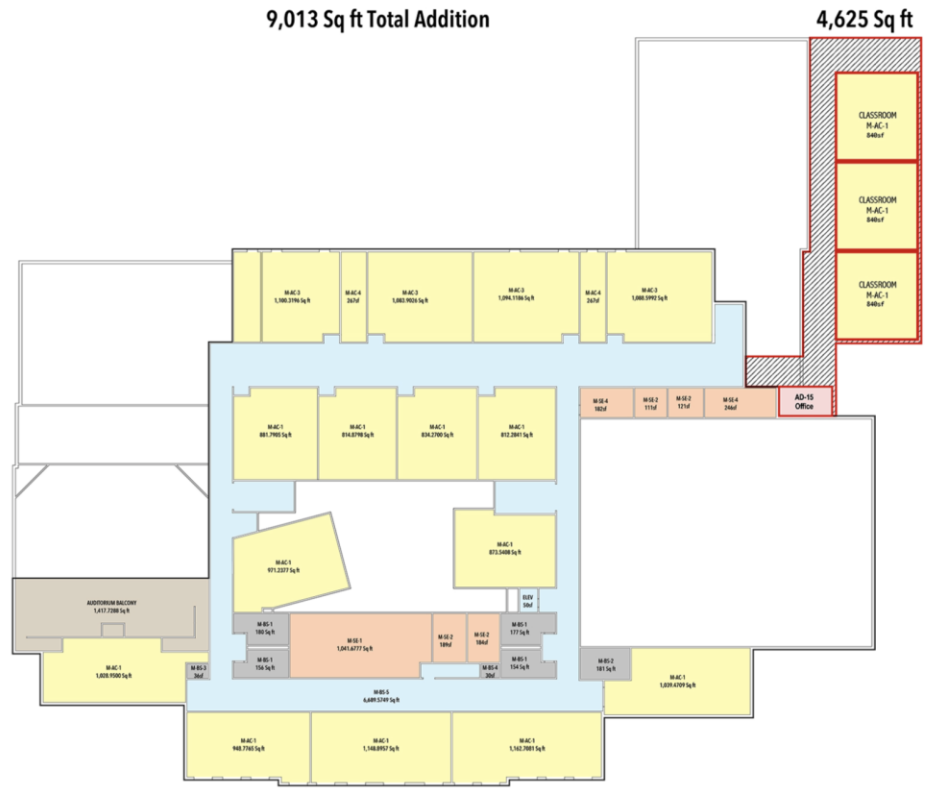
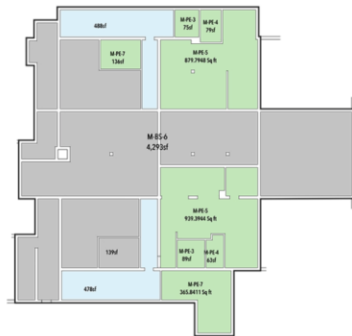

## FLOOR PLAN - UPPER LEVEL

1/16"=1'-0"

36,425 Gross Sq ft

## FLOOR PLAN - BASEMENT LEVEL

1/16"=1'-0"

9,141 Gross Sq ft

# Kilbourne Middle School - CURRENT CONCEPT



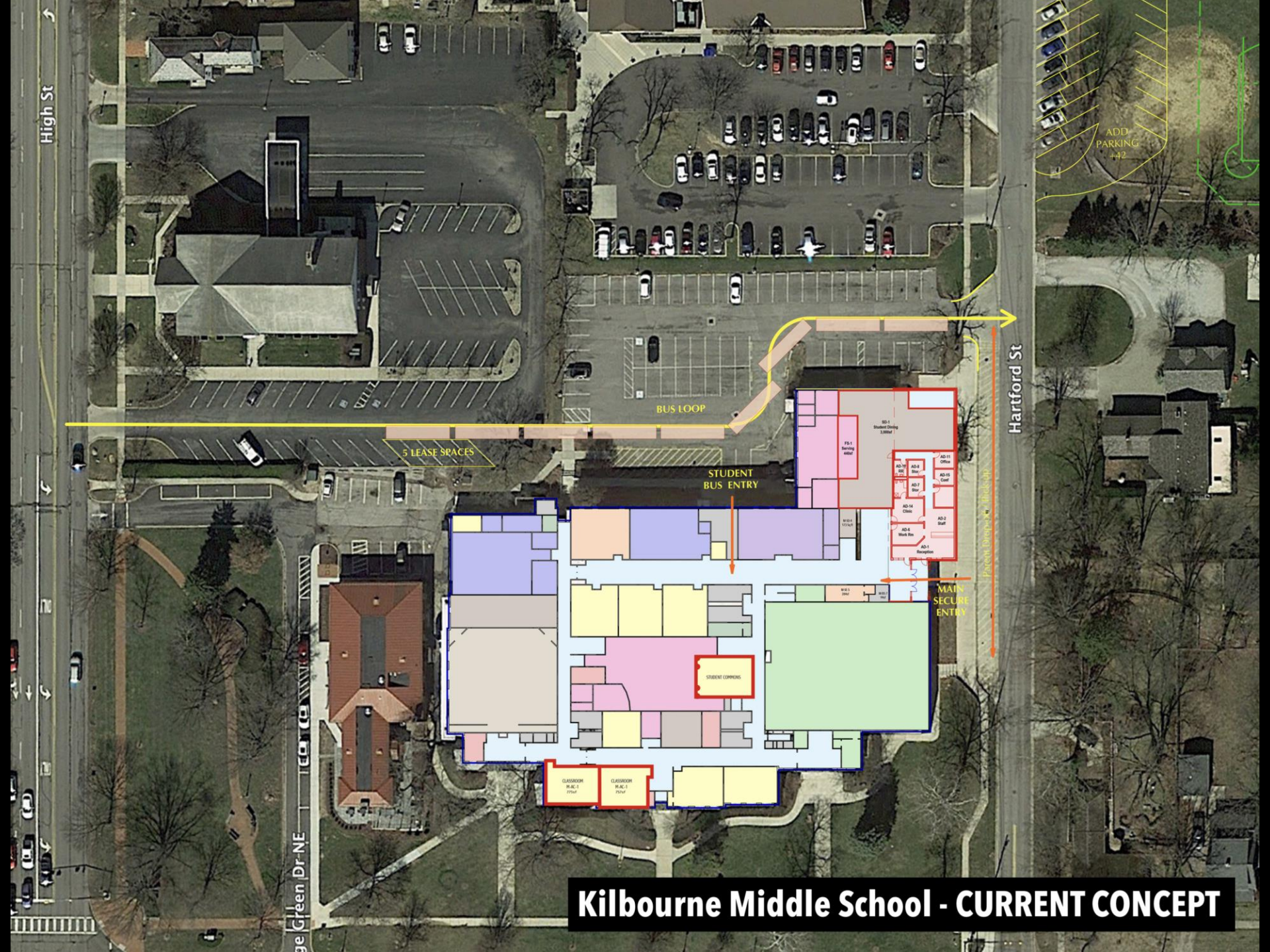

High St

George Green Dr NE

Hartford St

5 LEASE SPACES

BUS LOOP

STUDENT  
BUS ENTRY

MAIN  
SECURE  
ENTRY

ADD  
PARKING  
+42

Kilbourne Middle School - CURRENT CONCEPT



E Stafford Ave

Hartford St

ADD  
PARKING  
+42



**Kilbourne Middle School - CURRENT CONCEPT**







### Worthingway Middle School

750

#### OPPORTUNITIES / NEEDS

- ADD academic classrooms
- larger student dining
- secure entry/admin location
- site drop-off separation

#### CHALLENGES

- tight site accomodation
- existing traffic patterns
- relocation of track ?
- swing space

# Worthingway Middle School - Existing Site



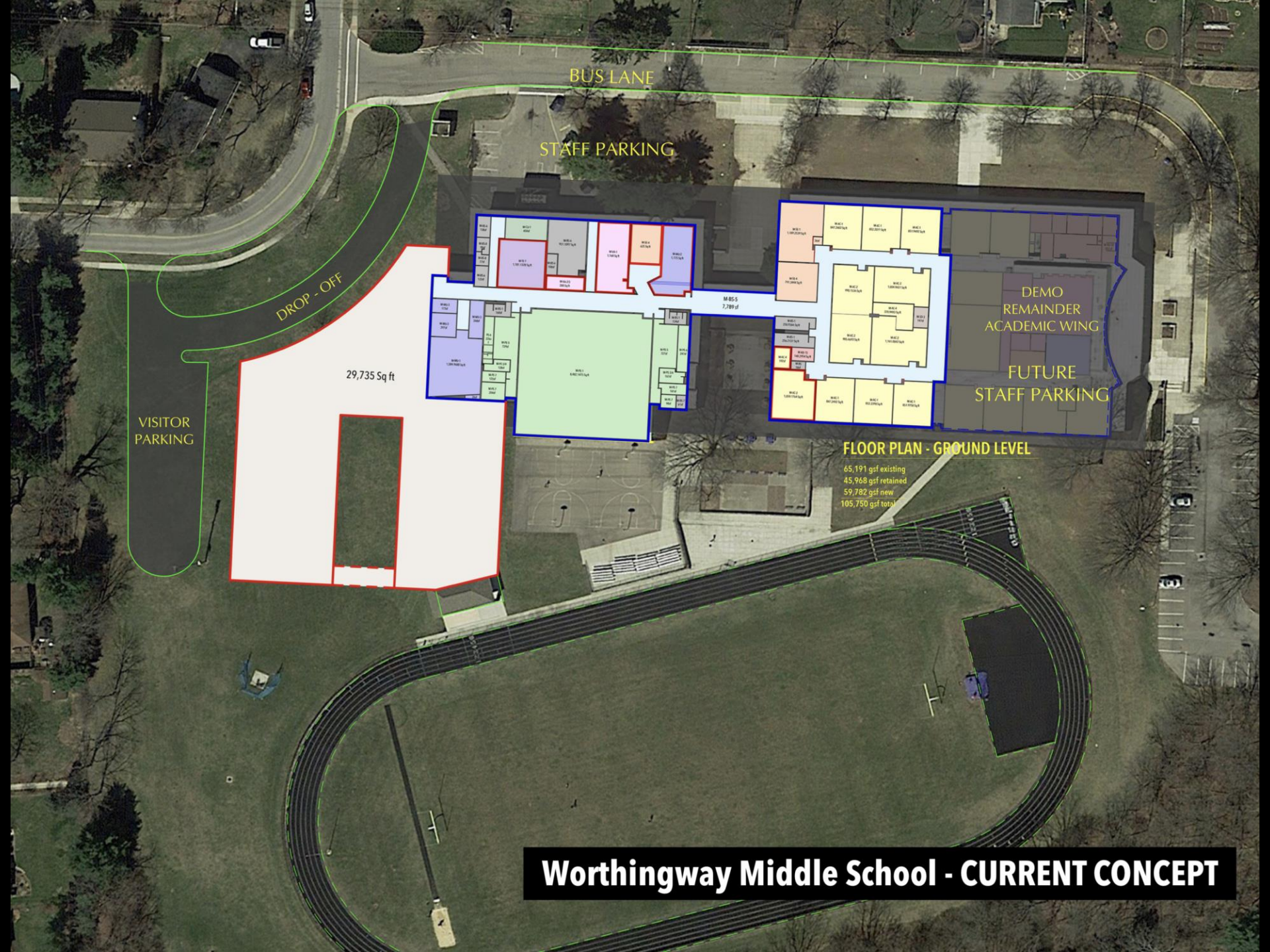

BUS LANE

STAFF PARKING

DROP - OFF

VISITOR PARKING

29,735 Sq ft

MB55  
7,899 sf

DEMO  
REMAINDER  
ACADEMIC WING

FUTURE  
STAFF PARKING

FLOOR PLAN - GROUND LEVEL

65,191 gsf existing  
45,968 gsf retained  
59,782 gsf new  
105,750 gsf total

**Worthingway Middle School - CURRENT CONCEPT**





## Worthingway Middle School - CURRENT CONCEPT